

1	Type	Board Lens	
2	Resolution	1.3MP	
3	Image Format	1/2.7"	
4	Image Circle	φ6.8mm(MAX)	
5	EFL	3.6mm	
6	TTL	22.15mm	
7	F/NO.	2.0	
8	FFL (M)	5.53mm	
9	BFL (O)	6.05mm	
10	For Sensor	1/2.7"	
11	F.O.V	Horizontal	70.5°
12		Vertical	51.2°
13		Diagonal	105.8°
14	TV Distortion	<-13%	
15	Relative Ill.	>60%	
16	Chief Ray Angle	<13.8°	
17	M.O.D	0.1m~∞	
18	Mount Type	M12*P0.5	
19	Dimension Figure	φ14.0*L16.62mm	
20	Lens Structure	2G2P	
21	IR-Filter	Non IR	
22	Weight	3.0g	
23	Iris Operation	Fixed	
24	Zoom Operation	Fixed	
25	Focus Operation	Manual	
26	Operating Temperature	-20° ~+60°	
27	Storage Temperature	-20° ~+60°	

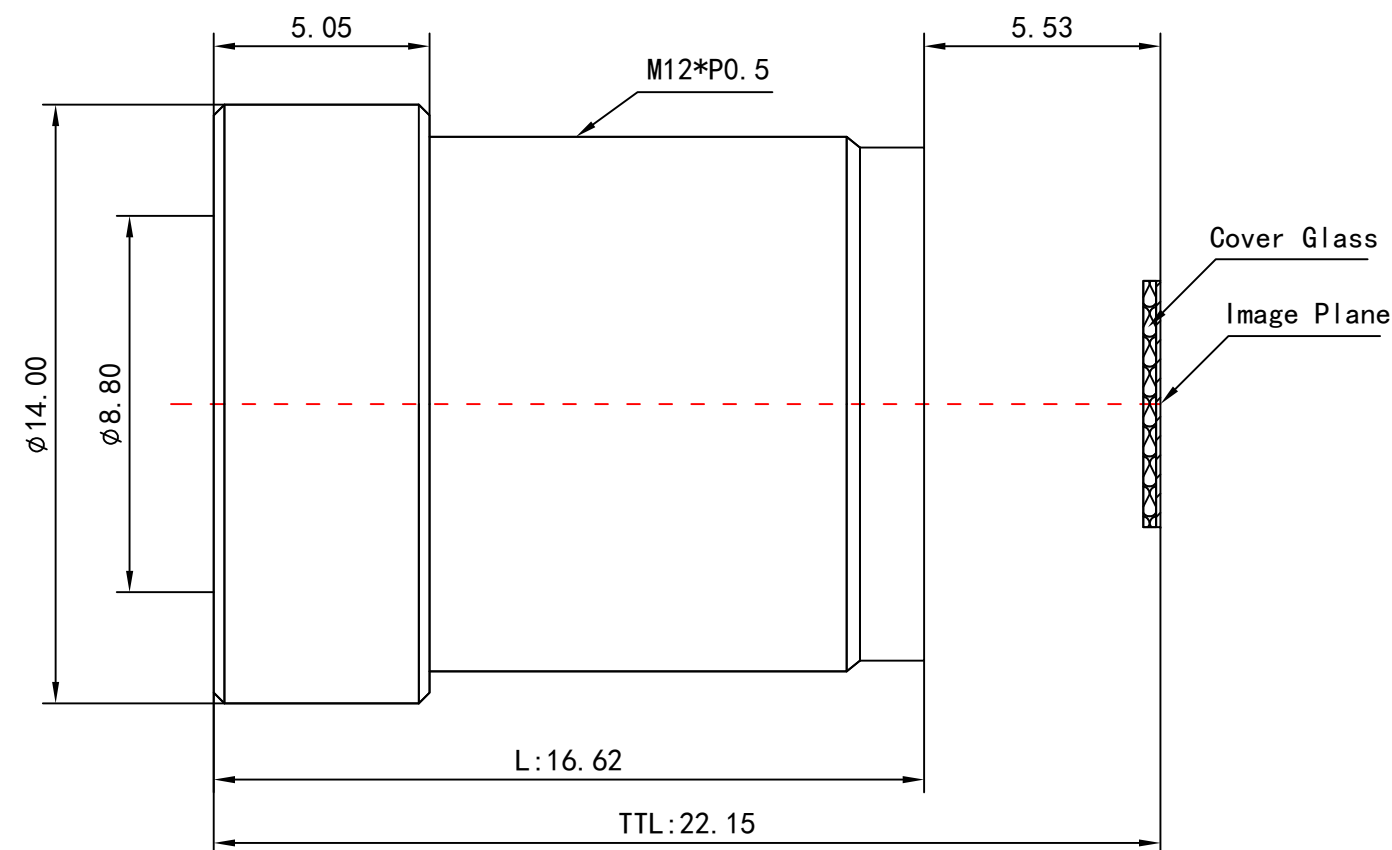
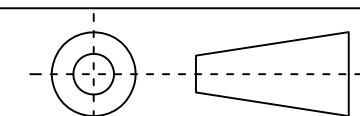

Scale	Remark	Tolerances	Date	Revised		福州创安光电科技有限公司 FUZHOU CHUANGAN OPTICS CO., LTD
4: 1	X	± 0.2	2019-07-05	CH895A Rev1.0		
	X.0	± 0.15				
Units	X.00	± 0.10	Design	Linda	2016-08-01	
	X.000	± 0.001	Checked	Anna	2016-08-01	
mm	Angle	± 0.5°	Approval	Sanmu	2016-08-01	

3D Angle Projection