

1	Type	Pinhole Lens	
2	Resolution	MP	
3	Image Format	1/2.7"	
4	Image Circle	φ6.7mm(MAX)	
5	EFL	3.7mm	
6	TTL	14.56mm	
7	F/NO.	2.5	
8	FFL (M)	5.65mm	
9	BFL (O)	6.12mm	
10	For Sensor	1/2.7"	
11	F.O.V	Horizontal	90°
12		Vertical	70°
13		Diagonal	110°
14	TV Distortion	<-13%	
15	Relative Ill.	>55%	
16	Chief Ray Angle	<20°	
17	M.O.D	0.1m~∞	
18	Mount Type	M12*P0.5-6g	
19	Dimension Figure	φ12.00*L8.91mm	
20	Lens Structure	4G	
21	IR-Filter	Non-IR	
22	Weight	1.4g	
23	Iris Operation	Fixed	
24	Zoom Operation	Fixed	
25	Focus Operation	Manual	
26	Operating Temperature	-20° ~+85°	
27	Storage Temperature	-20° ~+85°	

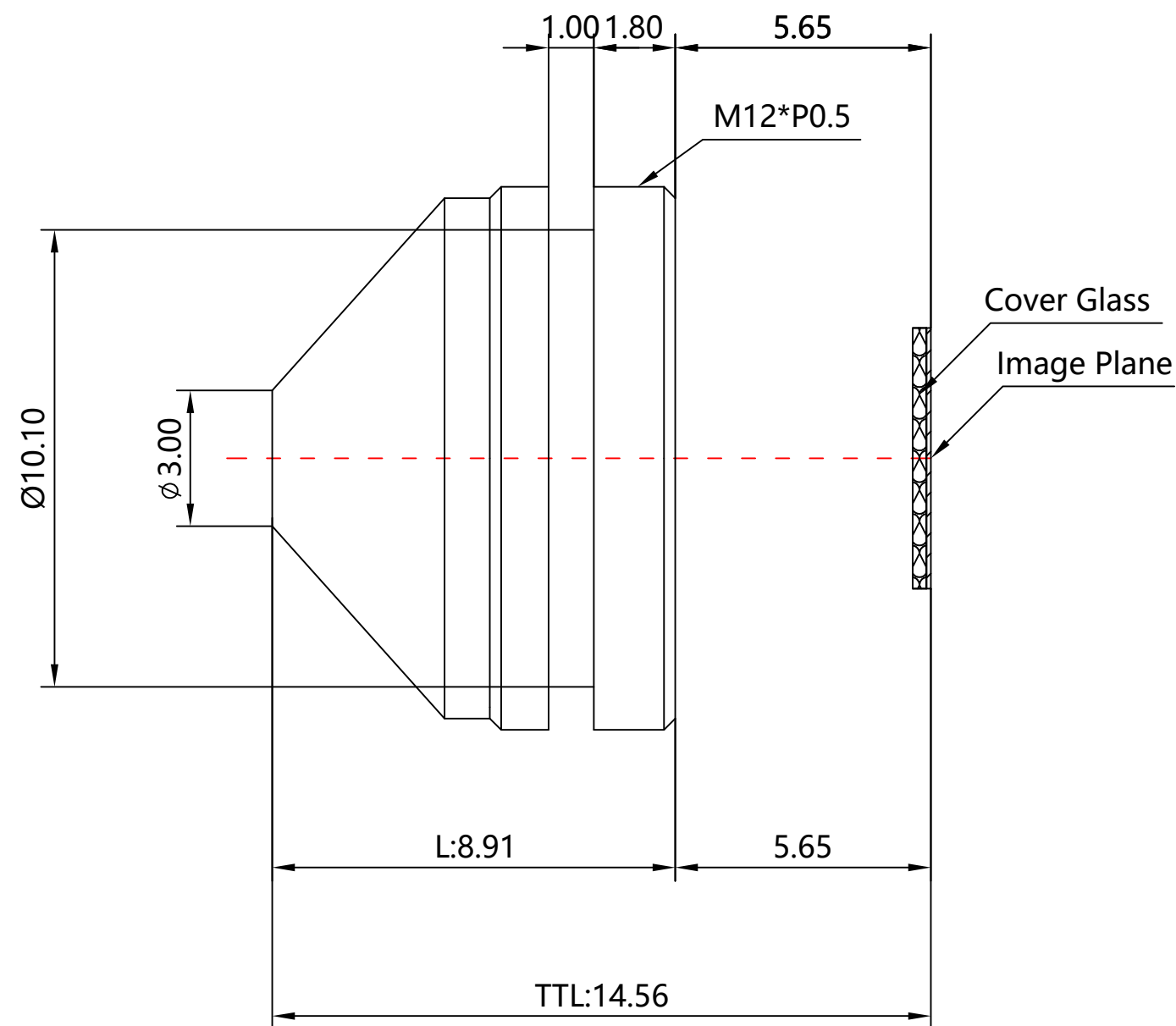
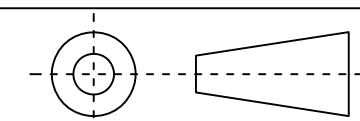

Scale	Remark	Tolerances	Date	Revised		福州创安光电科技有限公司 FUZHOU CHUANGAN OPTICS CO., LTD
5: 1	X	± 0.2	2022-10-28	CH1928B Rev1.0		
	X.0	± 0.15				
Units	X.00	± 0.10	Design	Linda	2017-01-15	
	X.000	± 0.001	Checked	Anna	2017-03-19	
mm	Angle	± 0.5°	Approval	Sanmu	2017-03-27	

3D Angle Projection